

NIBC

**NATIONAL INVESTMENT BANKING
COMPETITION & CONFERENCE**



NIBC 2017 WESTERN CANADA CONFERENCE

Event Venue

Shangri-La Hotel

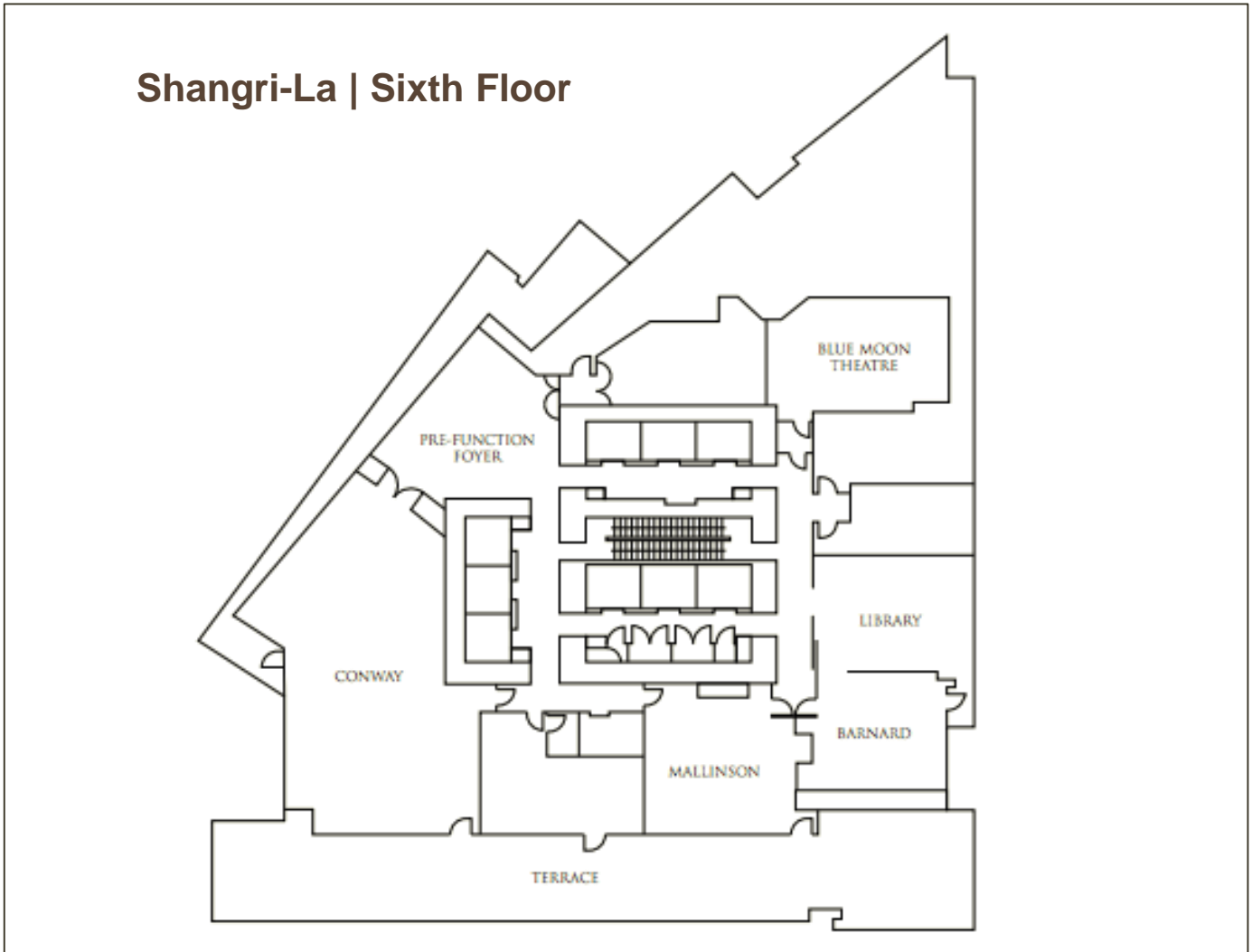

Event Logistics

Conference Itinerary

Western Canada Conference (Thursday, October 12 th , 2017)		
8:30am – 9:00am	Foyer	Registration
9:00am – 9:30am	Conway	Industry Overview
9:30am – 11:00am		Corporate Finance Workshop Mr. Tim Vipond
11:30am – 12:00pm		Keynote Fireside Chat Kathy Butler
12:00pm – 1:00pm		Investment Banking Industry Panel Q&A
1:00pm – 1:30pm	Conway	Lunch Break
1:30pm – 5:00pm	Conway Library	Investment Banking Simulation
5:00pm – 6:00pm	Conway	Fireside Chat Randy Smallwood
6:00pm – 9:00pm	Conway	Wine & Cheese Live Entertainment
9:00pm – 10:00pm	Pink Elephant	Dinner
10:00pm – 2:00am	Drai's	Evening Event



Transportation

Directions to Pink Elephant

1. Head southwest on Thurlow St toward Alberni St.
2. Turn right onto Alberni St

Estimated Walking Time: 2 minutes

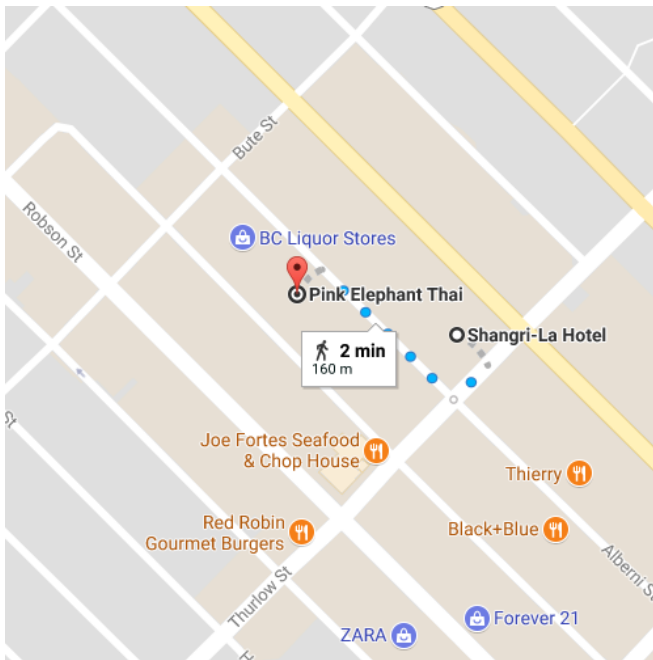

Directions to Drai's

1. Head northeast on Thurlow St toward W Georgia St.
2. Walk 1.5 minutes, destination will be on your left.

Estimated Walking Time: 3 minutes

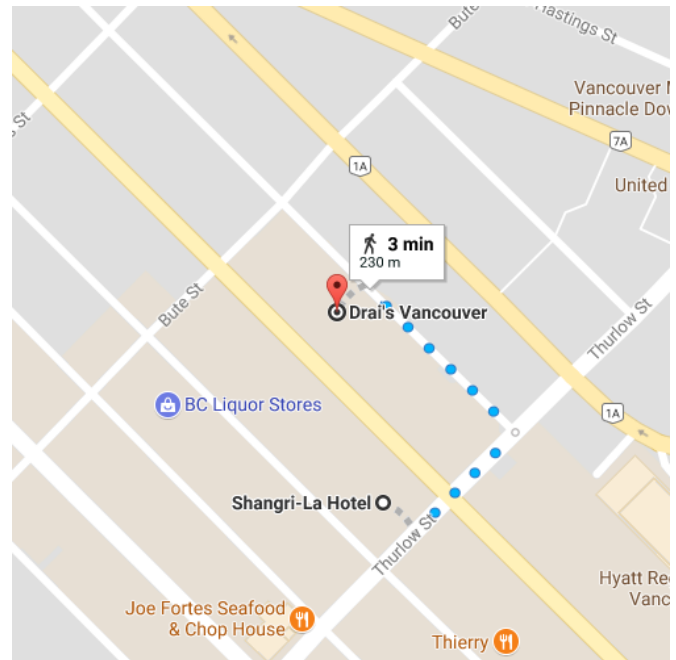

Restaurants Nearby

- Italian Kitchen
- Pink Elephant Thai
- Subway
- Tim Horton's
- The Keg
- Urban Fare



Conference Overview

Keynote Speakers



KEYNOTE FIRESIDE CHAT

Ms. Kathy Butler

Managing Director & Head of British Columbia, CIBC Capital Markets

Kathy Butler joined CIBC Capital Markets 20 years ago and has been involved in a number of mergers and acquisitions advisory mandates, as well as debt and equity financings for clients in sectors such as technology, telecom, consumer retail, industrial products, and forestry.

Ms. Butler holds an MBA (Honours) from the Rotman School of Management at the University of Toronto and a Bachelor of Commerce in Finance (Honours) from the Sauder School of Business at the University of British Columbia. She represented the technology industry on the BC Jobs and Investment Board and is currently on the Board of Governors of the Business Council of British Columbia. Ms. Butler is on the board of CIBC World Markets Inc., CIBC Children's Foundation and St. George's Foundation, and a Partner of Social Venture Partners Vancouver.



KEYNOTE FIRESIDE CHAT

Mr. Randy Smallwood

President & CEO, Wheaton Precious Metals

Kathy Butler joined CIBC Capital Markets 20 years ago and has been involved in a number of mergers and acquisitions advisory mandates, as well as debt and equity financings for clients in sectors such as technology, telecom, consumer retail, industrial products, and forestry.

Ms. Butler holds an MBA (Honours) from the Rotman School of Management at the University of Toronto and a Bachelor of Commerce in Finance (Honours) from the Sauder School of Business at the University of British Columbia. She represented the technology industry on the BC Jobs and Investment Board and is currently on the Board of Governors of the Business Council of British Columbia. Ms. Butler is on the board of CIBC World Markets Inc., CIBC Children's Foundation and St. George's Foundation, and a Partner of Social Venture Partners Vancouver.



Investment Banking Q & A Panel

This panel is composed of experienced Investment Bankers discussing and answering questions pertaining to the industry, lifestyle and practices, client relationship fundamentals, and career opportunities in this field. The panel is expected to be highly interactive and aims to illustrate the life of an Analyst and Associate in an investment bank. The panel is comprised of a moderator leading the session while delegates will be given the opportunity to ask questions during the session.



Mr. Haroon Chaudhry
Associate, BMO Capital Markets



Mr. Adam Potvin
Analyst, TD Securities



Ms. Emily Davies
Analyst, RBC Capital Markets



Mr. Chris Ting
Analyst, Scotiabank

Conference Overview

Case Simulation



INVESTMENT BANKING SIMULATION

Mr. Tim Vipond

*CEO, Corporate Finance Institute®
Vice President, SHOES.COM*

Tim is the Vice-President, Corporate Finance, for fast-growing Shoes.com, where he was recognized by Business in Vancouver as one of the city's Top 40 Under 40 in 2015 for his work, including the acquisition of Shoeme.ca and OnlineShoes.com. He also runs the Corporate Finance Institute, providing practical training on financial modelling and applications of finance for any professional.

Tim joined CIBC World Markets in Vancouver in 2005, and later joined Scotiabank Global Banking and Markets in 2007, where he managed portfolios of high-net-worth clients worth a combined \$120 million.

Outside of his current role at Shoes.com, Tim has worked on side projects such as Mathers Pacific Capital Inc., which he founded in 2013. He still runs the venture, which provides practical training for students and financial professionals.

Tim holds a Bachelor of Arts degree from Dartmouth College and an MBA from the University of British Columbia's Sauder School of Business. Tim also has a Business Valuation Certificate and Financial Modeling Certificate from the Corporate Finance Institute.

Investment Banking Simulation

Delegates will be given the opportunity to experience, first-hand, a significant aspect of investment banking. Using a completed DCF valuation, a set of comparables and precedent transactions, and a template pitch book, delegates will be given 2 hours to value a business, a company, or structure an M&A transaction. They will then present to investment banking professionals who will act as clients in the presentation and Q&A. The simulation will conclude with a debrief and feedback.

Be recognized, nationwide.

Corporate Sponsors



RBC Capital Markets



BMO  Capital Markets



About NIBC

Founded in 2007, the National Investment Banking Competition & Conference (NIBC) brings together over 1,600 students from 100 universities and 150 professionals in an annual case competition and conference. NIBC was founded on the guiding principle of giving students from any background an equal opportunity to develop and measure their skillset in investment banking on a global stage. With the generous assistance of a committed Board of senior finance professionals, NIBC has become one of the most authentic and interactive investment banking events for international graduate and undergraduate students.

nibc.ca

Organizing Team

Karsten Lee (Director, Competition)
Nicole Ponto (Director, Conference)
Hovy Qiu (Director, Case Development)
Joseph Liu (Director, Marketing)
Caitlyn Yu (Director, Internal)
Olya Kubliy (Director, Training)
Jamie Farrell (Associate, Competition)
Michael Tam (Associate, Conference)
Lucien Lu (Associate, Marketing)
Jonathan Young (Associate, Marketing)
Josh Dogor (Associate, Marketing)
Cameron Strukoff (Associate, Case Development)
Peter Yuan (Associate, Case Development)
Elisa Liu (Associate, Internal)

Board Members

Tracey McVicar (Managing Partner, CAI Private Equity)
Kathy Butler (Managing Director, CIBC World Markets)
Chris Tsoromocos (Managing Director, Maxam Capital)
Rizvan Dhalla (Managing Director, Morgan Stanley)
Harry Pokrandt (Managing Director, Espresso Capital)
Scott Powell (President, MDA Training)
Jordan Anderson (Portfolio Manager, bciMC)
Philip Chua (Macquarie Capital 2016)
Michael Scott (Vice President, RBC Capital Markets)
Gint Austrins (Equity Analyst, Global Securities)

Case Committee

Amardeep Chandi (Associate, KKR)
Dipak Kamdar (Junior Associate, McKinsey & Co.)
Noam Gilead (Associate, J.P. Morgan)
Martin Haakonsen (Associate, TD Securities)
Brenden Lee (Oaktree Capital 2016)
Jacky So (Senior Associate, BOCOM International)
David Lam (Analyst, Macquarie Capital)
Nicole Dee (Analyst, Goldman Sachs)

Contact Information

The NIBC Organizing Team would like to thank you for participating in NIBC 2017. For further enquiries, please feel free to contact:

Ali Geum | Director, Conference | (778) 928-5115
Kevin Nan | Associate, Conference | (604) 352-1545
Amir Zanjani | Associate, Conference | (778) 867-7671